

#### 4.1 Selection of location

To upgrade the operation efficiency and accuracy of precision machine, a proper foundation is required.

It is recommended to locate CNC Teach-in Lathe Machines in a plant with permanent temperate ( about 20°C ) and without the influence of damping, chemical gas or trembling. The machine body is not allowed to be exposed to sunshine or rains.

Please be sure not to install the machines adjacent to Punching machine, Welding machine, Spark EDM machine. Otherwise. It will result in poor performance.

A distance of at least 850mm is required from machine to wall and objects or between machines as well as easy opening of the door of electric cabinet.

#### 4.2 Diagram of minimum space for KL-2600, KL-3000 & KL-3200 Series

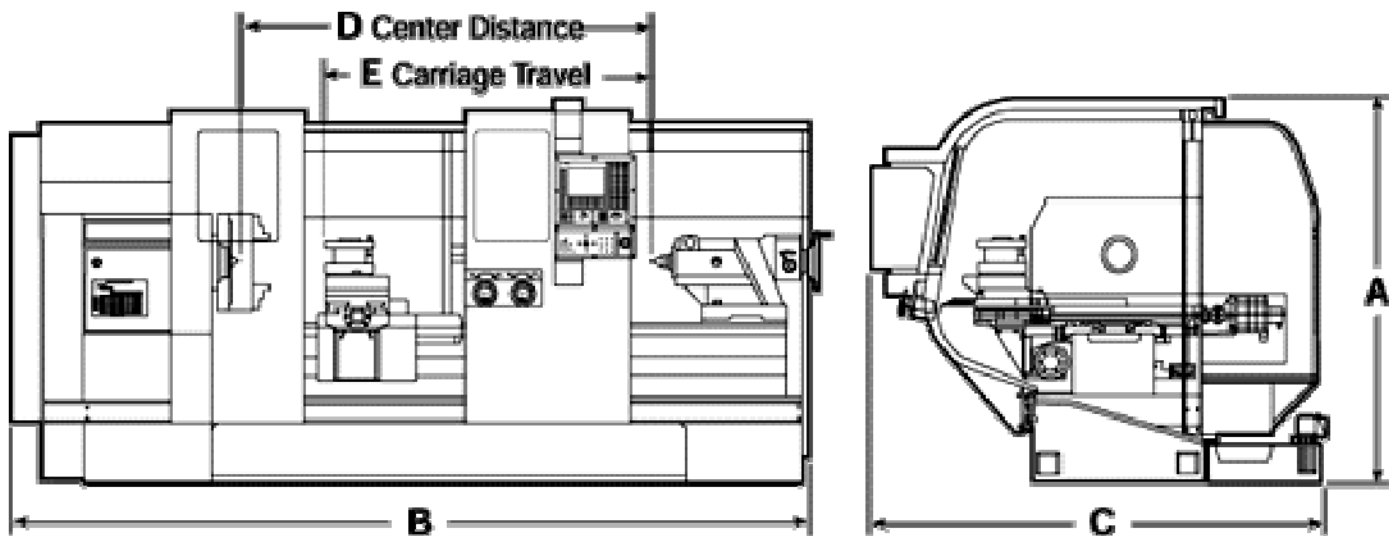

Model	A	B	C	D	E	Weight
KL-2660	1900 mm	3420 mm	2000 mm	1500 mm	1200 mm	5200 Kgs
KL-3060	(74.8")	(126")	(78.7")	(60")	(47.2")	
KL-3080	1900 mm	3920 mm	2000 mm	2000 mm	1700 mm	5400 Kgs
KL-3080	(74.8")	(154")	(78.7")	(80")	(67")	
KL-30120	1900 mm	4920 mm	2000 mm	3000 mm	2700 mm	6000 Kgs
KL-30120	(74.8")	(193.7")	(78.7")	(120")	(106")	
KL-3260	1900 mm	3420 mm	2000 mm	1500 mm	1200 mm	5400 Kgs
	(74.8")	(126")	(78.7")	(60")	(47.2")	
KL-3280	1900 mm	3920 mm	2000 mm	2000 mm	1700 mm	5800 Kgs
	(74.8")	(154")	(78.7")	(80")	(67")	
KL-32120	1900 mm	4920 mm	2000 mm	3000 mm	2700 mm	6300 Kgs
	(74.8")	(193.7")	(78.7")	(120")	(106")	

### 4.3 Foundation

(a) With special torque-resistant capability at the base, this machine requires no particular foundation. Only provide 15cm thick of concrete on the floor and leave space for components adjustment for leveling. (Refer to figure 5) for foundation diagram.

#### 26/30/32 - 60/80

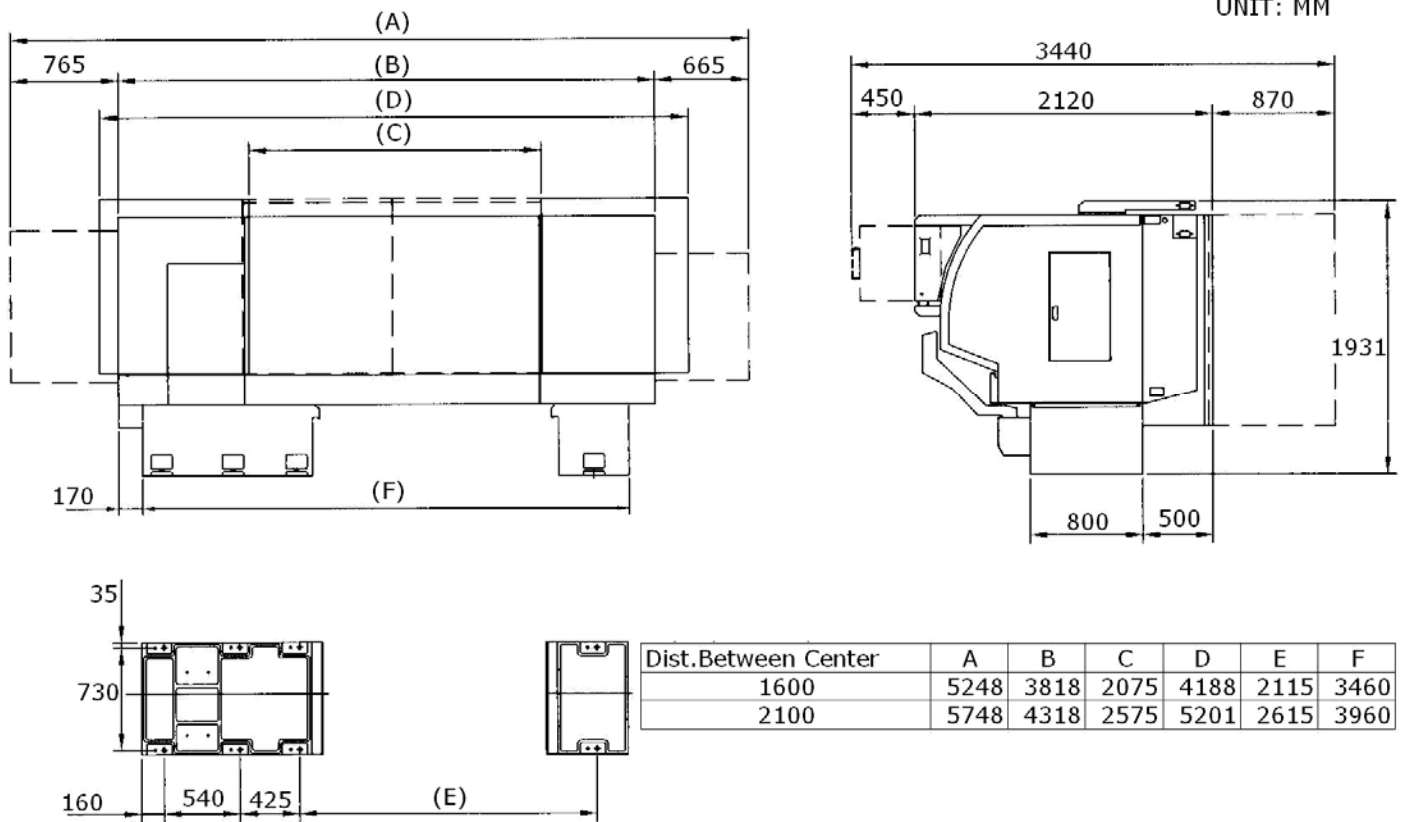

#### 26/30/32 - 120

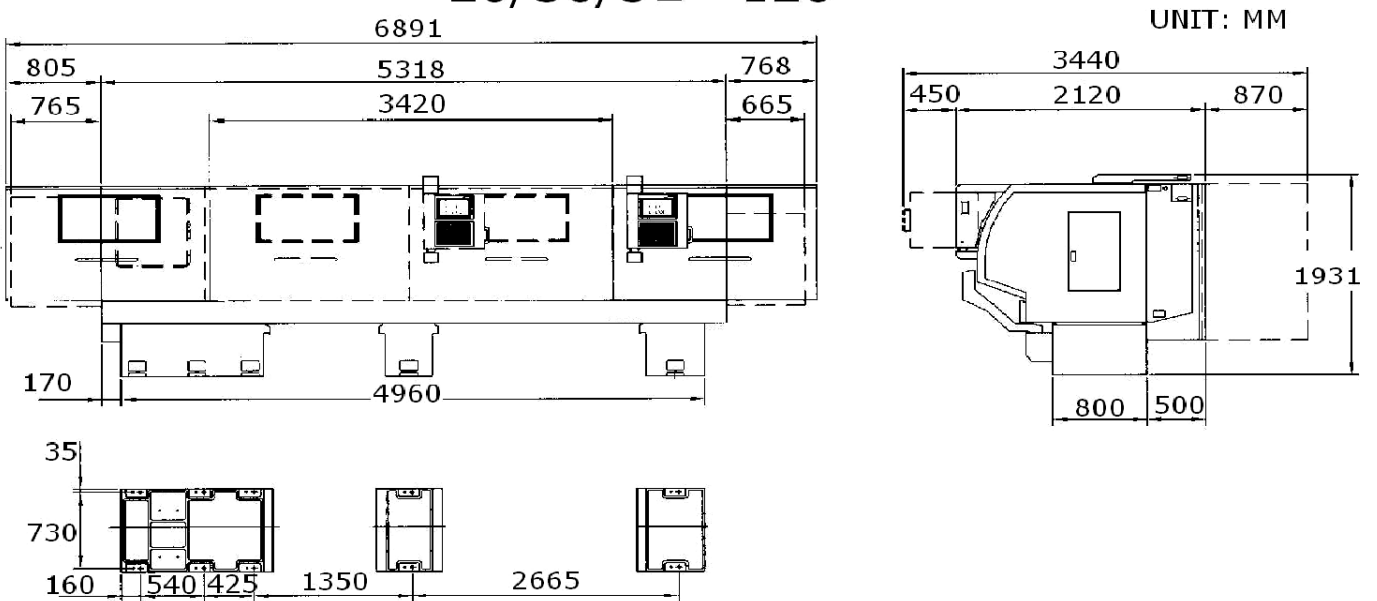

# Dimensional drawing

26/30/32 - 160

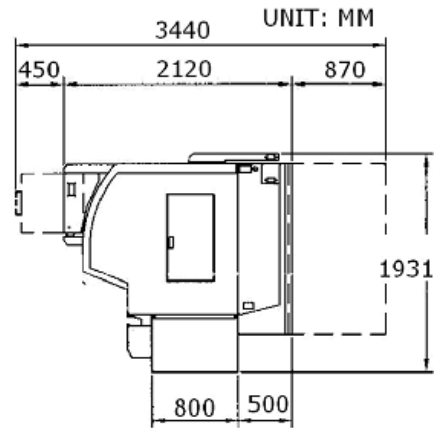
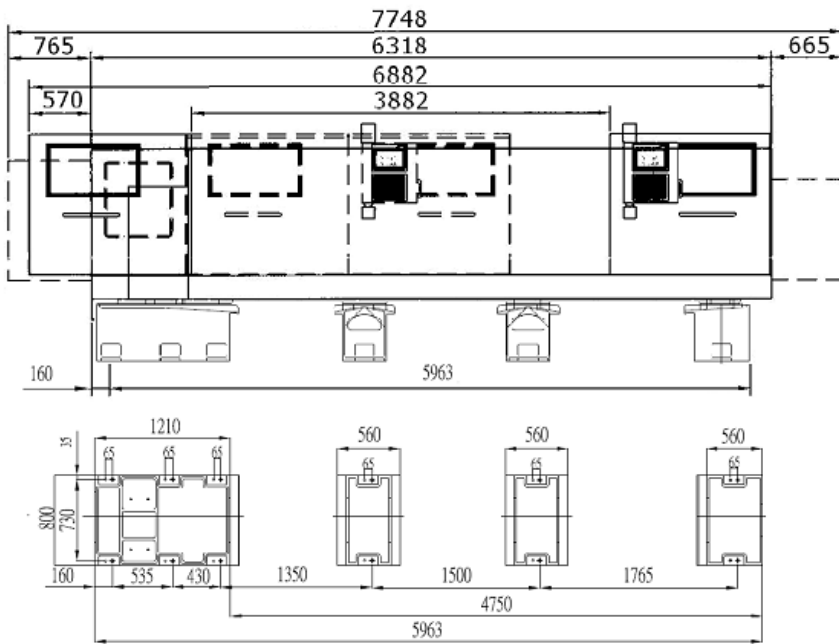

26/30/32 - 200

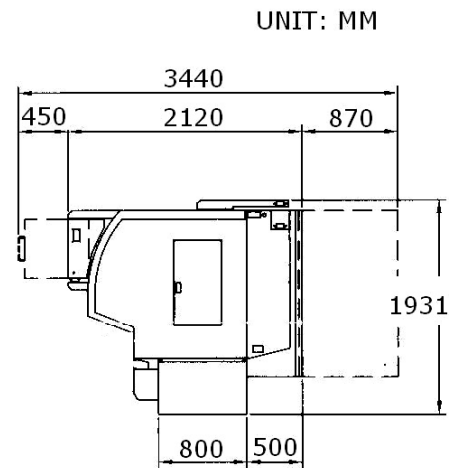
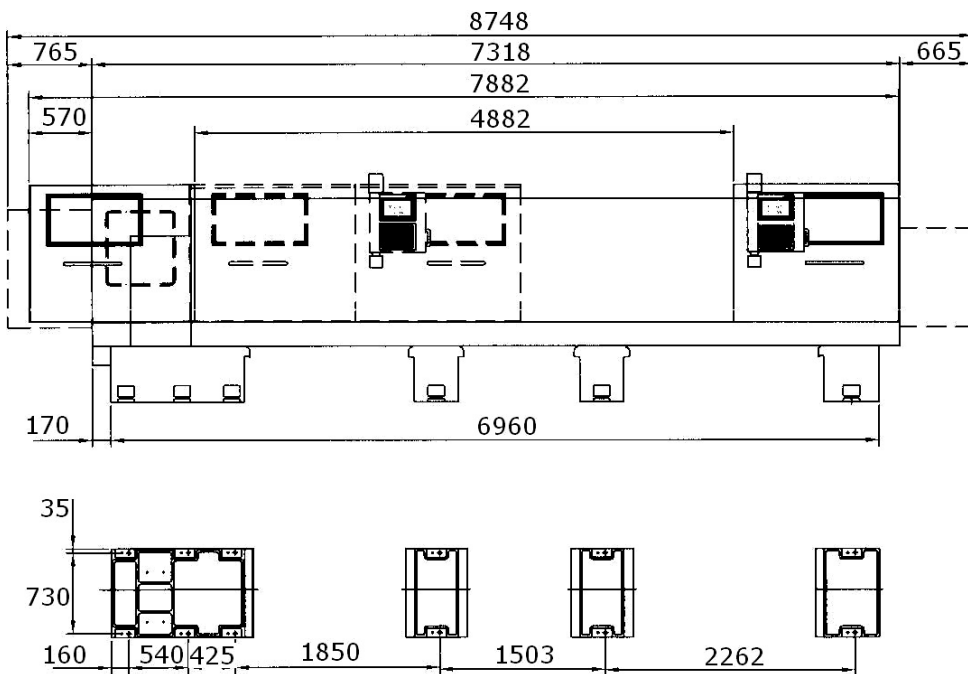

### 4.3.1 Interrupted diagram of tool rack

Unit : mm

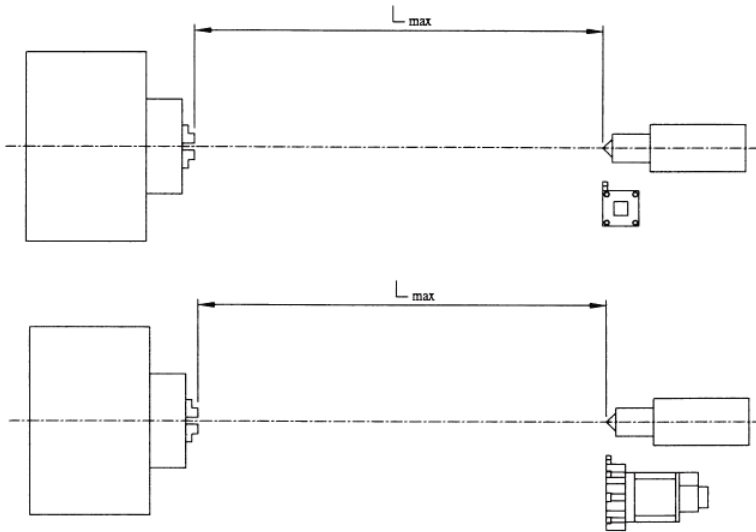

TURRET	MODEL	L max.
4 WAY Toolpost	KL-3060	1400
	KL-3080	1900
	KL-30120	2900
	KL-30160	3900
	KL-30200	4900
8 Station Turret	KL-3060	1250
	KL-3080	1750
	KL-30120	2750
	KL-30160	3750
	KL-30200	4750

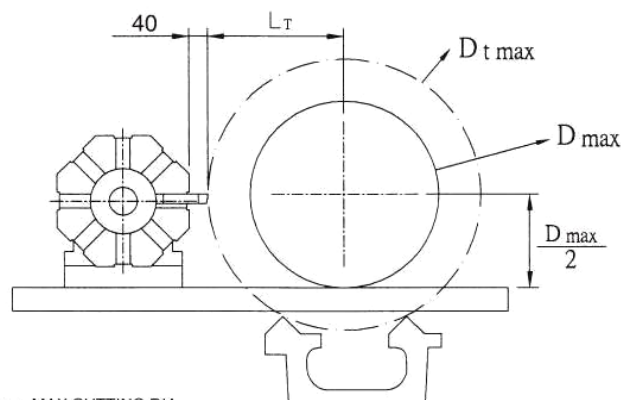
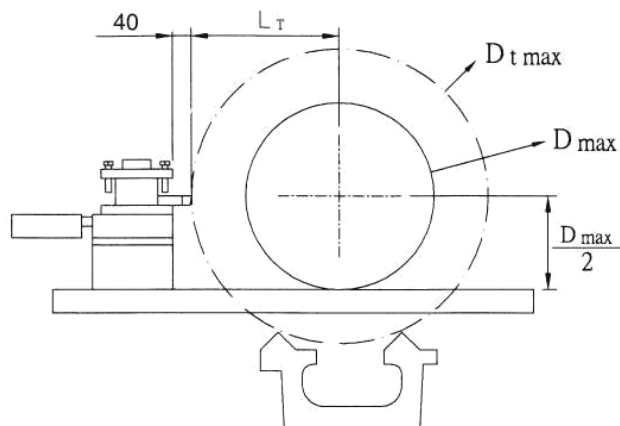

D<sub>t max</sub>=MAX CUTTING DIA.  
D<sub>max</sub>=MAX DIA. OF WORKPIECE  
L<sub>T</sub>=MAX CUTTING LENGTH

TURRET	MODEL	D max.	Dt max.	LT
4 WAY Toolpost	KL-3000	Dia.500 mm	Dia.770 mm	385 mm
8 Station Turret	KL-3000	Dia.500 mm	Dia.690 mm	345 mm

## Standard Working Capacity for KL-3000 and 3200 Series

### KL-3000 Series with LS-200/8-Station Turret

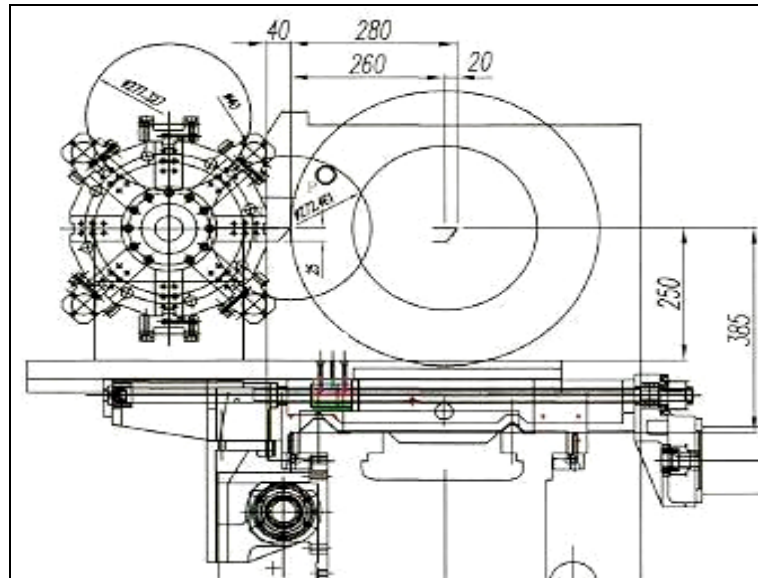

### KL-3200 Series with LS-200/8-Station Turret

