

機械規格 / Machine Specifications

| 研磨範圍 General Capacity | | |
|---|---|-----------------------|
| 砂輪中心到工作台距離 | Distance between wheel center and table | 140 mm |
| 最大研磨直徑 | Max. grinding diameter | Ø150 mm |
| 砂輪主軸 Grinding Spindle | | |
| 砂輪直徑 | Grinding wheel Diameter | Ø150 x Ø40 x 40t (mm) |
| 砂輪馬達 | Spindle speed | 3450 rpm (60HZ) |
| 砂輪角度 | Sliding Angle | -3° ~ +25° |
| 軸向行程 | | |
| X軸行程 | X axis | 400 mm |
| Z軸行程 | Z axis | 150 mm |
| A軸行程 | A axis | -3° ~ +25° |
| B軸行程 | B axis | -115° ~ +115° |
| U軸行程 | U axis | 60mm |
| W軸行程 | W axis | 70mm |
| Y軸行程 | Y axis | 20mm |
| V軸行程 | V axis | 200mm |
| 軸向伺服及冷卻馬達 Axis Motor and Coolant System | | |
| 砂輪主軸馬達 | Spindle motor | 2.2 kw |
| 修砂主軸馬達 | Spindle motor | 0.12 kw |
| X軸 | X axis | 1 kw (Servo) |
| Z軸 | Z axis | 1 kw (Servo) |
| A軸 | A axis | 1 kw (Servo) |
| B軸 | B axis | 1.5 kw (Servo) |
| U軸 | U axis | 0.4kw (Servo) |
| W軸 | W axis | 0.4kw (Servo) |
| Y軸 | Y axis | 0.4kw (Servo) |
| V軸 | V axis | 0.4kw (Servo) |
| 冷卻過濾馬達 | Coolant | 0.19 kw (1/4hp) |
| 自動潤滑 | Lubrication | 0.19 kw (1/4hp) |
| 機械規格 Dimension | | |
| 佔地面積 | Floor space | 2130 x 1715 x1850 mm |
| 機械重量 | Weight | 1500 kg |

機械尺寸 / Dimension

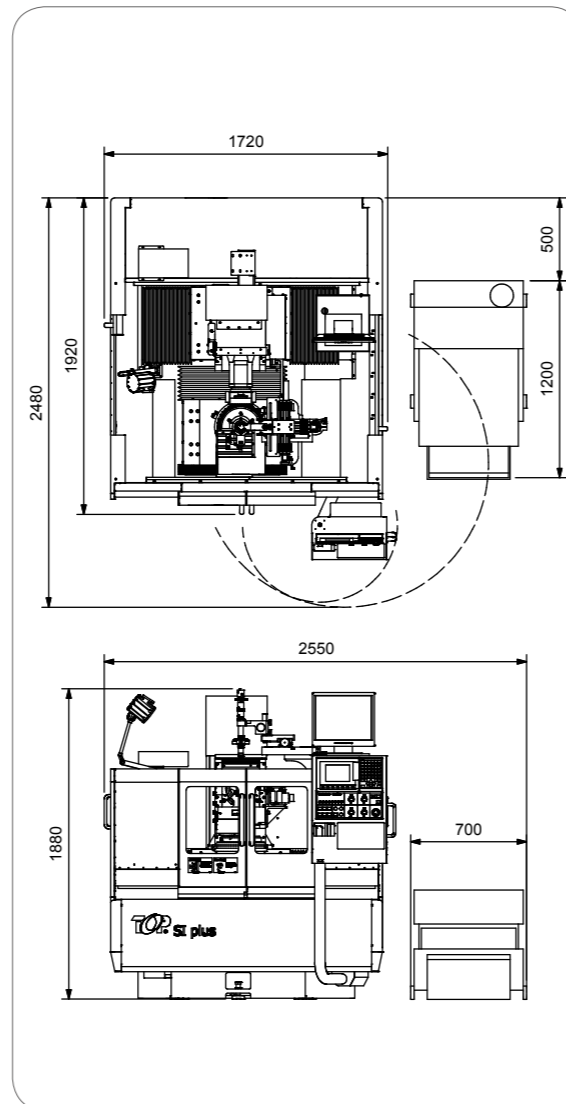

本公司保有規格設計變更的權利，不再另行通知。
All specifications are subject to change without prior notice.

TOP
TOPWORK
ISO 9001 · CE

PCD & PCBN GRINDER

萬能工具磨床

SI PLUS



鼎維工業股份有限公司
TOPWORK Industry Co., Ltd.

台中市40755工業區6路9號
No.9, 6th Road, Taichung Industrial District, Taichung
40755, Taiwan.
TEL : 886-4-23581558 FAX : 886-4-23581268
E-mail : topwork@ms12.hinet.net



www.topwork.com.tw

**SI-series is a PCD & PCBN grinding machine designed for grinding.
Metal insert tools. Woodworking insert tools.
Profile insert.**

特色

- 磨床設計有各式附件，便於快速調整、磨削和檢測，一次裝設可完成上述所有工序。
- 不僅用於PCD、PCBN的刀具研磨，也可用於捨棄式的鎢鋼刀具。

Feature

- Equipped with various attachment, fast adjustment, grinding and measurement.
- Performed on different tools such as; PCD、PCBN and carbide.



砂輪主軸

- 砂輪主軸採用高精度的斜角滾珠軸承
- 高剛性、低震動的機體設計



Wheel spindle

- High precision angular-contact ballbearing.
- Maximum stability; Minimum vibration.

線性滑軌

- X,Z軸滑軌 使用高精度的滾珠螺桿驅動
- 中央潤滑系統



Linear guideway

- X and Z axis linear guideway is driven by high precision ballscrew.
- No maintenance needed with central lubrication system. (Equipped with central lubrication system: no maintenance needed.)

軸向配置圖/Axis Configuration

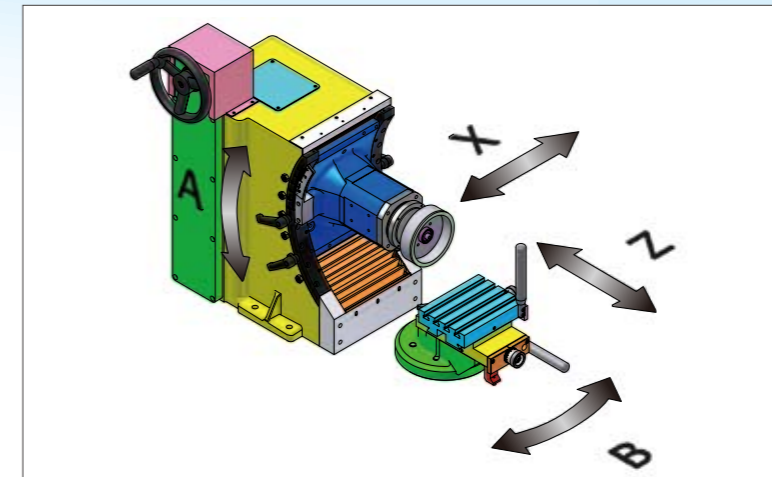

控制器

- 三菱控制器
- 簡單上手的操作介面
- 可編寫MACRO程式

Controller

- MITSUBISHI controller.
- User-friendly operational panel.
- Easy editable macro program.



C.C.D 量測系統

- 高精度的CCD量測系統
- 簡單刀具定位
- 放大倍率從28~180倍無段變焦

C.C.D System

- High precision measurement.
- Easy to locate fixed position.
- Magnification with zoom system from x28 to x180.



**標準附件
Standard Accessories**

- 紙袋過濾系統
- 快速鎖緊座
- 工件座
- 角度顯示裝置
- C.C.D量測系統
- 17" 螢幕
- Paper Filter Coolant system
- Quickly clamping fixture
- Tool stand
- Angle Display
- C.C.D System
- 17" Monitor

**特殊選件
Optional**

- 主軸變速裝置
- 電磁紙袋冷卻裝置
- 快速鎖緊座
- 砂輪修整器
- 探針
- 工作台(U,W 軸伺服)
- Variable speed attachment (1000~4000 rpm)
- Magnetic separator & paper filter coolant system
- Quickly clamping fixture 8、12、32 mm
- Wheel Dresser
- Touch Probe
- Working table (U,W axis servo)